

**NOTICE!!**

**These documents have been scanned!**

**Do not place un-scanned documents beneath this notice!**

**Do not remove this notice from this file!**

GPO Jacket No. 560-102  
Print Order 61540  
Rise Business Services, LLC  
Job=AZ15 4/26/2019



Box Number= AZ15002



Claim Begin-End: AMC450144-AMC450144

1 Initial Receipt



AZ15002-30

AMC450400-AMC453366

**United States Department of the Interior**  
**Bureau of Land Management**  
 DIV OF LANDS, MINRLS & ENERGY  
 ONE N CENTRAL AVE  
 PHOENIX, AZ 85004 -4427  
 Phone: 602-417-9200

Receipt

No: 4119247

<b>Transaction #:</b> 4232706	
<b>Date of Transaction:</b> 03/23/2018	
<b>CUSTOMER:</b>	
	GRE INC 331 S RIO GRANDE ST STE 201 SALT LAKE CITY,UT 84101-1136 US

ENTERED  
 MAR 27 2018  
 RAm

LINE #	QTY	DESCRIPTION	REMARKS	UNIT PRICE	TOTAL
1	1.00	LOCATABLE MINERALS / MINING CLAIMS-NEW,UNADJUD, ONE OR MORE AUTH NOS / NEW MINING CLAIM PROCESSING FEE CASES: AMC450144/\$20.00		- n/a -	20.00
2	1.00	LOCATABLE MINERALS / MINING CLAIMS-NEW,UNADJUD, ONE OR MORE AUTH NOS / NEW MINING CLAIMS LOCATION FEE CASES: AMC450144/\$37.00		- n/a -	37.00
3	1.00	LOCATABLE MINERALS / MINING CLAIMS-NEW,UNADJUD, ONE OR MORE AUTH NOS / NEW MINING CLAIMS LOCATION FEE CASES: AMC450144/\$155.00		- n/a -	155.00
<b>TOTAL:</b>					<b>\$212.00</b>

PAYMENT INFORMATION			
1	AMOUNT:	212.00	POSTMARKED: N/A
	TYPE:	CHECK	RECEIVED: 03/23/2018
	CHECK NO:	003770	
	NAME:	GRE INC 2091 E MURRAY HOLLADAY RD #22E SALT LAKE CITY UT 84117 US	

REMARKS

This receipt was generated by the automated BLM Collections and Billing System and is a paper representation of a portion of the official electronic record contained therein.

**NOTICE!!**

**These documents have been scanned!**

**Do not place un-scanned documents beneath this notice!**

**Do not remove this notice from this file!**

GPO Jacket No. 560-102  
Print Order 61540  
Rise Business Services, LLC  
Job=AZ15 4/26/2019



Box Number= AZ15002



Claim Begin-End: AMC450144-AMC450144

2 Correspondence



AZ15002-30

AMC450400-AMC453366



# United States Department of the Interior

BUREAU OF LAND MANAGEMENT

Arizona State Office

One North Central Avenue, Suite 800

Phoenix, Arizona 85004-4427

[www.blm.gov/az/](http://www.blm.gov/az/)



NOV 05 2018

In Reply Refer To:

3800 (9200) RM

AMC449841, AMC450144

CERTIFIED MAIL - RETURN RECEIPT REQUESTED No. 9214 8901 9403 8374 6980 72

## NOTICE

WILLIAM SHIRK : This Notice Affects the Claims  
1011 CONDOR DR : Shown in the Block Below.  
GRAND PRAIRIE, TX 75051-3348 :

---

AMC449841, AMC450144

ABRIL 2, ABRIL 3

---

### Mining Claim Location Notice(s) – Amendment(s) Required

Pursuant to Title 43 Code of Federal Regulations (CFR) 3832.1, the Bureau of Land Management (BLM), Arizona State Office, received your notice(s) of location for recording mining claims. In accordance with 43 CFR 3832.12, the claim(s) listed above cannot be accepted as filed and must be amended as noted below.

- AMC449841 - The tie-in description states corner 1 of the claim is 1,668 feet North 36°55'19" West, from the northeast corner of T. 18 S., R. 23 E., sec. 3. This would place the claim in T. 17 S., R. 23 E., sec. 35 not sec. 34 as described on the location notice. If the tie-in was the northwest corner of T. 18 S., R. 23 E., sec. 3, the claim would be located in T. 17 S., R. 23 E., sec. 34.
- AMC450144 - The tie-in description states corner 1 of the claim is 1,537 feet North 23°58'7" East, from the northeast corner of T. 18 S., R. 23 E., sec. 3. This would place the claim in T. 17 S., R. 23 E., sec. 35 not sec. 34 as described on the location notice. If the tie-in was the northwest corner of T. 18 S., R. 23 E., sec. 3, the claim would be located in T. 17 S., R. 23 E., sec. 34.

An amendment must be filed for each claim listed in the block above to correct the defects identified. There is a \$15 BLM processing fee for each amendment. The amendments must be received by BLM within 30-days of your receipt of this notice. If the amendments are not

received within the 30-day timeframe, the mining claims will be declared null and void.

If additional information is required, please contact RéAnn Myers at 602-417-9413. Please include your AMC serial number(s) on all correspondence.



Lucas Lucero  
Deputy State Director  
Lands, Minerals and Energy Division

Enclosure(s)



Date Produced: 11/12/2018

ConnectSuite Inc.:

The following is the delivery information for Certified Mail™/RRE item number 9214 8901 9403 8374 6980 72. Our records indicate that this item was delivered on 11/10/2018 at 05:01 p.m. in GRAND PRAIRIE, TX 75051. The scanned image of the recipient information is provided below.

Signature of Recipient :

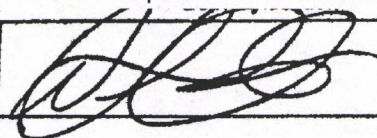
Signature	
Printed Name	

Address of Recipient :

Delivery Address	1011 CONDOR DR
------------------	----------------

Thank you for selecting the Postal Service for your mailing needs. If you require additional assistance, please contact your local post office or Postal Service representative.

Sincerely,  
United States Postal Service

The customer reference number shown below is not validated or endorsed by the United States Postal Service. It is solely for customer use.

Customer Reference Number: C1067015.6148197

**NOTICE!!**

**These documents have been scanned!**

**Do not place un-scanned documents beneath this notice!**

**Do not remove this notice from this file!**

GPO Jacket No. 560-102  
Print Order 61540  
Rise Business Services, LLC  
Job=AZ15 4/26/2019



Box Number= AZ15002



Claim Begin-End: AMC450144-AMC450144

3 Transfers



AZ15002-30

AMC450400-AMC453366



A 449 123

449 841

450 144

When Recorded Mail To:  
GRE Inc  
331 S. Rio Grande Street  
Suite #201  
SLC, UT 84101

RECEIVED  
BLM AZ STATE OFFICE  
2018 AUG 21 P 2:02  
PHOENIX, ARIZONA

### Quit Claim Deed

Quit Claim Deed Exempt Per ARS 11-1134 A6

THE GRANTOR(S): GRE, Inc., of the City of Salt Lake, County of Salt Lake, State of Utah 84101

For and in consideration of monetary compensation or trade, do CONVEY and QUIT CLAIM to:

THE GRANTEE(S):

- William Shirk of 1011 Condor Drive, in the city Grand Prairie, county of Dallas, state of TX 75051,

In the form of Sole Ownership, all interest in the following described Mining Claim Property(s) situated in the County of Cochise, in the State of Arizona, to wit:

- ✓ Abril, AMC #449123 Located in Section 34, Township 17S, Range 23E
- ✓ Abril 2, AMC#449841 Located in Section 34, Township 17S Range 23E
- ✓ Abril 3, AMC#450144 Located in Section 34, Township 17S Range 23E

Hereby releasing and waiving all rights under and by virtue of the Mining and Location laws of the State of Arizona.

Dated this 14th day of August, 2018

Signature(s) of Grantor(s):

JESSICA SHUMAN GRE, Inc. Representative

Name & Address of Preparer: JESSICA SHUMAN, an Agent for GRE, Inc. -  
331 S. Rio Grande Street, Suite #201, SLC, UT 84101

SIGNED   
Signature of Claim owner's agent JESSICA SHUMAN

BY JESSICA SHUMAN  
Printed name of Claim owner's agent  
STATE OF UTAH  
COUNTY OF SALT LAKE

On the \_\_\_\_\_ day of \_\_\_\_\_, 2018, JESSICA SHUMAN did personally appear before me, the Undersigned notary public in and for the County of Salt Lake, in said State of Utah, Who acknowledged to me that he/she signed it freely and voluntarily for the purposes therein mentioned.

Notary Public of Salt Lake County, Utah

My commission expires on:

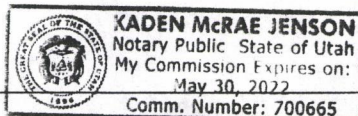

ENTERED  
AUG 27 2018  
BY: BDS

#4241586



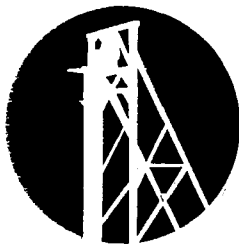

**GOLD RUSH**  
EXPEDITIONS

8/15/2018

GRE, Inc.  
331 S. Rio Grande Street  
Suite #201  
SLC, UT 84101

Arizona BLM

Re: 1 Quit Claim Deed

RECEIVED  
BLM STATE OFFICE  
2018 AUG 21 P 2:02  
PHOENIX, ARIZONA

Dear Arizona BLM Cashier,

Please find enclosed 1 Quit Claim Deed (s) for filing. I understand there is a fee for recording this documents. Please find a check addressed to the BLM for these fees. Please send the recorded documents back to GRE, Inc.

Thank you for your time and efforts.

Sincerely,

GRE Accounting  
385-218-2138  
[accounting@goldrushexpeditions.com](mailto:accounting@goldrushexpeditions.com)  
[www.goldrushexpeditions.com](http://www.goldrushexpeditions.com)

2091 E Murray Holladay Rd. Ste. 22E, Salt Lake City, UT, 84117

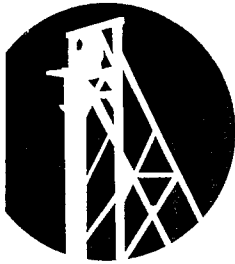

# GOLD RUSH

EXPEDITIONS

GRE Inc

331 S. Rio Grande Street

Suite #201

SLC, UT 84101



7018 0680 0001 1809 7549



\$4.75 UN POSTAGE  
FIRST CLASS  
PERMIT NO. 101  
PHOENIX, AZ

RECEIVED  
BLM AZ STAFF OFFICE  
2018 AUG 21 P 2:02  
PHOENIX, ARIZONA

Arizona BLM  
Attn: Cashier  
One N. Central Ave., Ste. 800  
Phoenix, AZ 85004



**United States Department of the Interior**  
**Bureau of Land Management**  
 DIV OF LANDS, MINRLS & ENERGY  
 ONE N CENTRAL AVE  
 PHOENIX, AZ 85004 -4427  
 Phone: 602-417-9200

Receipt

No: 4241586

<b>Transaction #:</b> 4357001	
<b>Date of Transaction:</b> 08/22/2018	
CUSTOMER:	
GRE INC 331 S RIO GRANDE ST STE 201 SALT LAKE CITY,UT 84101-1136 US	

LINE #	QTY	DESCRIPTION	REMARKS	UNIT PRICE	TOTAL
1	1.00	LOCATABLE MINERALS / MINING CLAIMS- NOT NEW-UNADJUD,ONE AUTH NO. ONLY / MINING CLAIM MONEY RECEIVED CASES: AMC449123/\$30.00	TRF/3	- n/a -	30.00
<b>TOTAL:</b>					<b>\$30.00</b>

PAYMENT INFORMATION			
1	AMOUNT:	30.00	POSTMARKED: N/A
	TYPE:	CHECK	RECEIVED: 08/21/2018
	CHECK NO:	004440	
	NAME:	GRE INC 2091 E MURRAY HOLLADAY RD STE 22E SALT LAKE CITY UT 84117 US	

REMARKS

This receipt was generated by the automated BLM Collections and Billing System and is a paper representation of a portion of the official electronic record contained therein.

**NOTICE!!**

**These documents have been scanned!**

**Do not place un-scanned documents beneath this notice!**

**Do not remove this notice from this file!**

GPO Jacket No. 560-102  
Print Order 61540  
Rise Business Services, LLC  
Job=AZ15 4/26/2019



Box Number= AZ15002



Claim Begin-End: AMC450144-AMC450144

4 Annual Filings



AZ15002-30

AMC450400-AMC453366

DEPARTMENT OF THE INTERIOR  
BUREAU OF LAND MANAGEMENT  
MINING CLAIMS

Run Date/Time: 8/20/2018

MC Maintenance Fees Paid Through the BLM Pay Portal  
(by Date Paid)

Page 203 Of 316

**CBS Receipt: 4235418**

Printed For Lead File # AMC450144

Agency Tracking ID: 1534267551

Assessment Year: 2019

Paid On: 8/14/2018

Number of BLM Serial Nr: 3

Total Amount Paid: \$465.00

Claim Name	BLM Serial No	Lead File No	Amount Paid
ABRIL	AMC449123	AMC449123	\$155.00
ABRIL 2	AMC449841	AMC449841	\$155.00
ABRIL 3	AMC450144	AMC450144	\$155.00

**United States Department of the Interior**

**Bureau of Land Management**

BUSINESS & SUPPORT SVCS DIV

ONE N CENTRAL AVE SUITE 800

PHOENIX, AZ 85004 -4427

Phone: 602-417-9200

Receipt

No:

4235418

<b>Transaction #:</b> 4350779	
<b>Date of Transaction:</b> 08/14/2018	
<b>CUSTOMER:</b>	
WILLIAM E SHIRK 1011 CONDOR DR GRAND PRAIRIE, TX 75051 US	

LINE #	QTY	DESCRIPTION	REMARKS	UNIT PRICE	TOTAL
1	1.00	LOCATABLE MINERALS / MINING CLAIMS- NOT NEW-UNADJUD, ONE AUTH NO. ONLY / MINING CLAIM MONEY RECEIVED <b>CASES: AMC449123/\$465.00</b>		- n/a -	465.00
<b>TOTAL:</b>					<b>\$465.00</b>

PAYMENT INFORMATION				
NOTE: Items will appear on credit card statement as "BLM O Mining Claim".				
1	AMOUNT:	465.00	POSTMARKED:	N/A
	TYPE:	CREDIT CARD	RECEIVED:	08/14/2018
	NAME:	WILLIAM E SHIRK 1011 CONDOR DR GRAND PRAIRIE TX 75051 US		
	CARD NO:	XXXXXXXXXXXX3166	AUTH CODE:	05046B
	NAME ON CARD:	WILLIAM E SHIRK		
	SIGNATURE:			

REMARKS

This receipt was generated by the automated BLM Collections and Billing System and is a paper representation of a portion of the official electronic record contained therein.

**NOTICE!!**

**These documents have been scanned!**

**Do not place un-scanned documents beneath this notice!**

**Do not remove this notice from this file!**

GPO Jacket No. 560-102  
Print Order 61540  
Rise Business Services, LLC  
Job=AZ15 4/26/2019



Box Number= AZ15002



Claim Begin-End: AMC450144-AMC450144

5 Miscellaneous



AZ15002-30

AMC450400-AMC453366

Amc 449841  
450144

12/3/2018

GRE, Inc.  
331 S. Rio Grande Street  
Suite #201  
SLC, UT 84101

Arizona BLM

Re: 2 Amended Notice of Locations

Dear Arizona BLM Cashier,

Please find enclosed 2 Amended Notice of Locations (s) for filing. I understand there is a fee for recording this documents. Please find a check addressed to the BLM for these fees. Please send the recorded documents back to GRE, Inc.

Thank you for your time and efforts.

Sincerely,

GRE Accounting  
385-218-2138  
[accounting@goldrushexpeditions.com](mailto:accounting@goldrushexpeditions.com)  
[www.goldrushexpeditions.com](http://www.goldrushexpeditions.com)

PHOENIX, ARIZONA

2018 DEC 10 P 2:50

RECEIVED  
BLM AZ STATE OFFICE

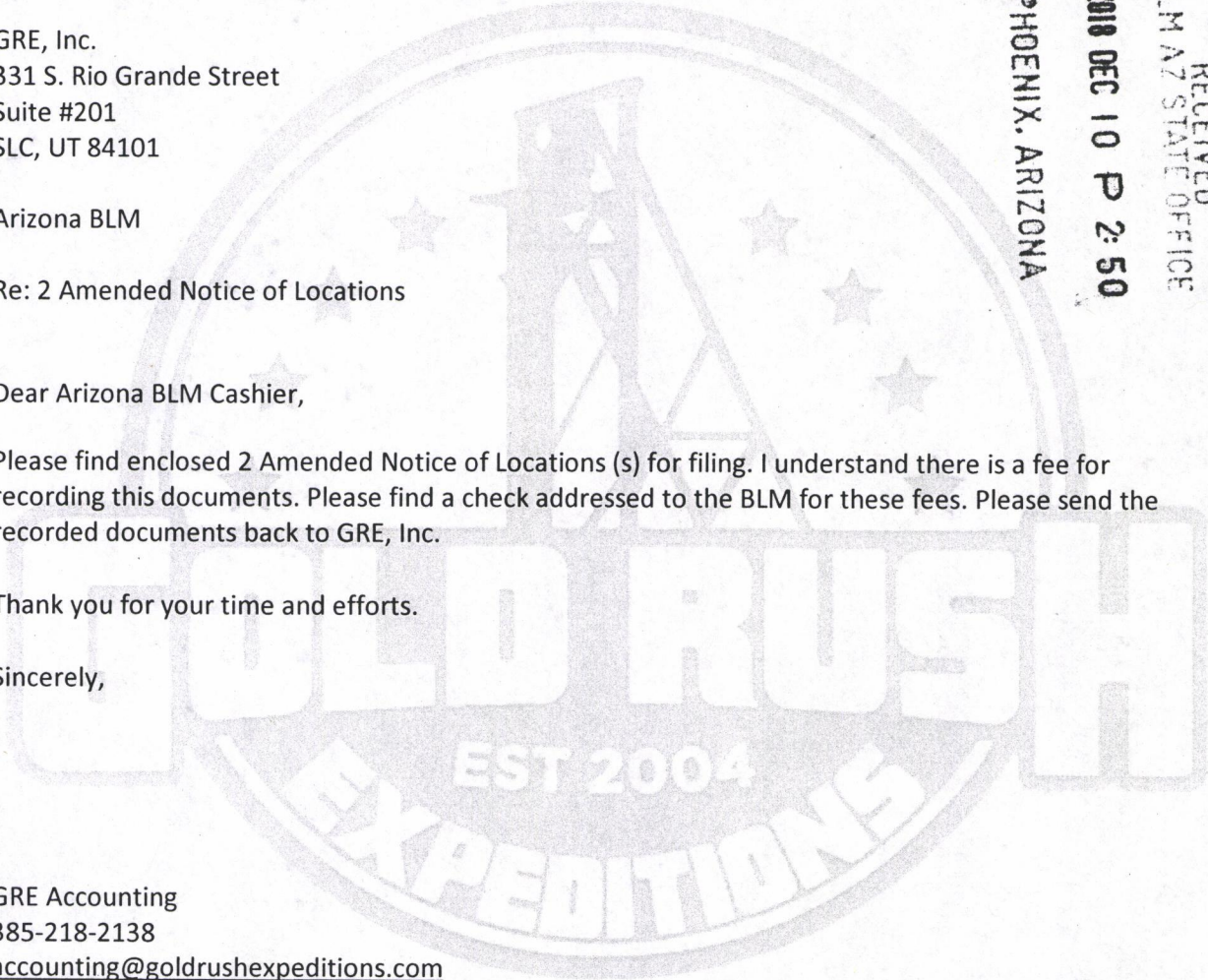



GRE Inc  
331 S. R  
SLC, UT 84101

CERTIFIED MAIL



7018 0680 0001 1811 7926



Arizona BLM  
Attn: Cashier  
One N. Central Ave., Ste. 800  
Phoenix, AZ 85004

RECEIVED  
BUREAU OF LAND MANAGEMENT  
STATE OF ARIZONA  
PHOENIX, ARIZONA  
2018 DEC 10 P 2:50

**United States Department of the Interior**  
**Bureau of Land Management**  
 DIV OF LANDS, MINRLS & ENERGY  
 ONE N CENTRAL AVE  
 PHOENIX, AZ 85004 -4427  
 Phone: 602-417-9200

Receipt

No: 4331522

<b>Transaction #:</b> 4448187	
<b>Date of Transaction:</b> 12/11/2018	
<b>CUSTOMER:</b>	
GRE INC 331 S RIO GRANDE ST STE 201 SALT LAKE CITY, UT 84101-1136 US	

LINE #	QTY	DESCRIPTION	REMARKS	UNIT PRICE	TOTAL
1	1.00	LOCATABLE MINERALS / MINING CLAIMS- NOT NEW-UNADJUD, ONE AUTH NO. ONLY / MINING CLAIM MONEY RECEIVED CASES: AMC449841/\$30.00	AMEND/2	- n/a -	30.00
<b>TOTAL:</b>					<b>\$30.00</b>

PAYMENT INFORMATION			
1	AMOUNT:	30.00	POSTMARKED: N/A
	TYPE:	CHECK	RECEIVED: 12/10/2018
	CHECK NO:	004641	
	NAME:	GRE INC 331 S RIO GRANDE ST STE 201 SALT LAKE CITY UT 84101-1136 US	

REMARKS

This receipt was generated by the automated BLM Collections and Billing System and is a paper representation of a portion of the official electronic record contained therein.

*FOR AMENDMENTS ON AMC 449841*

*AND AMC 450144.*

*635 ENTERED 2/6/2019, PM*

GRE Inc  
331 S. R  
SLC, UT 84101

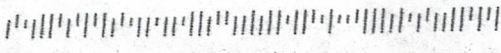

CERTIFIED MAIL



7018 0680 0001 1811 7926



Arizona BLM  
Attn: Cashier  
One N. Central Ave., Ste. 800  
Phoenix, AZ 85004

RECEIVED  
BLM STATE OF ARIZONA  
2018 DEC 10 P 2:50  
PHOENIX, ARIZONA



**GOLD RUSH**  
EXPEDITIONS

3/19/2018

GRE, Inc.  
331 S. Rio Grande Street  
Suite #201  
SLC, UT 84101

Arizona BLM

Re: Certificate of Location

Dear Arizona BLM Cashier,

Please find enclosed One Certificate of location (s) for filing. I understand there is a fee for recording this document. I have enclosed a check for the fees. Please send the recorded documents with a receipt back to GRE, Inc.

Thank you for your time and efforts.

Sincerely,

GRE Accounting  
385-218-2138  
[accounting@goldrushexpeditions.com](mailto:accounting@goldrushexpeditions.com)  
[www.goldrushexpeditions.com](http://www.goldrushexpeditions.com)

RECEIVED  
218 MAR 22 P 1 23  
PHOENIX, ARIZONA

**NOTICE!!**

**These documents have been scanned!**

**Do not place un-scanned documents beneath this notice!**

**Do not remove this notice from this file!**

GPO Jacket No. 560-102  
Print Order 61540  
Rise Business Services, LLC  
Job=AZ15 4/26/2019



Box Number= AZ15002



Claim Begin-End: AMC450144-AMC450144

6 Location Notices-Amendments and Supporting Documents



AZ15002-30 AMC450400-AMC453366

**DINING CLAIM STATUS REPORT**

Data Entered: 3/27/18 RAM

MTP Checked By: 3/27/18 RAM  
GEO Checked By: 3/27/18 RAM

LEAD SERIAL NUMBER: AMC 450144 thru AMC \_\_\_\_\_

**NUMBER OF CLAIMS & TYPE:**

- 1 LODE
- \_\_\_\_\_ PLACER
- \_\_\_\_\_ ASSOCIATION PLACER
- \_\_\_\_\_ MILL SITE
- \_\_\_\_\_ TUNNEL SITE

**CHARGES:**

Processing Fee @ \$20 =	\$	<u>20</u>
Location Fee @ \$37 =	\$	<u>37</u>
Maintenance Fee @ \$155 =	\$	<u>155</u>
Add'l Maint Fee for Assoc Placer =	\$	
<b>SUBTOTAL</b>	\$	
Other Fees	\$	
Other Fees	\$	
<b>TOTAL</b>	\$	<u>212</u>

TOTAL ACREAGE: \_\_\_\_\_ Per Claim  
(Placer Only)

NUMBER OF LOCATORS: \_\_\_\_\_

DOCUMENTS RECEIVED VIA: Over-the-Counter [ ] Mail [  ] TIMELY FILED: Yes [  ] No [ ]

LEGAL DESCRIPTION:	T	<u>175</u>	R	<u>235</u>	SEC	<u>34</u>
	T	_____	R	_____	SEC	_____
	T	_____	R	_____	SEC	_____
	T	_____	R	_____	SEC	_____
	T	_____	R	_____	SEC	_____

BLM [ ] FOREST SERVICE [ ] \_\_\_\_\_ SUBJ TO PL 359: Yes [ ] No [ ]  
WILDERNESS AREA [ ] \_\_\_\_\_

SPLIT ESTATE: N/A [ ] SX [ ] PX [ ] OTHER [ ] \_\_\_\_\_  
SRHA [ ] Was proper Notice filed if located on SHRA Land? Yes [ ] No [ ]

RECONVEYED MINERALS ON BLM LAND REQUIRE OPENING ORDER FROM 1944 TO 1993:  
Open to Entry On \_\_\_\_\_ N/A [ ]

COMMENTS/STATUS: VOID [ ] PARTIALLY VOID [ ] PVT MINERALS [ ] WITHDRAWN LANDS [ ]  
OTHER [ ] \_\_\_\_\_

[ ] Claimant acknowledges that portions of the following claim(s) site(s) may be void or voidable.

Printed Name of Claimant \_\_\_\_\_ Signature of Claimant \_\_\_\_\_

\*\*\*\*\*FINAL ADJUDICATION\*\*\*\*\*

DATE 10/3/2018 INITIALS [Signature]

AMC450144

**Amended LOCATION NOTICE FOR LODE MINING CLAIM**

NOTICE IS HEREBY GIVEN that the ABRIL 3 (AMC450144)

lode mining claim has been located by

GRE INC whose current mailing

address is 331 S RIO GRANDE STREET ST#201, SLC UT 84101

The general course of this claim is NW TO SE and it is

situated in COCHISE County, Arizona. This claim is 1500 feet in length and 600 feet in width.

The ABRIL 3 Lode Mining Claim is located pursuant to 43 C.F.R. 3832.12 (b), and described by metes and bounds, including a description of the tie to an official survey monument as follows:

Beginning at NORTH corner #1, thence 600 feet southwest at 225° to WEST corner #2, thence 1500 feet SOUTHEAST at 135° to SOUTH corner #3, thence 600 feet northeast at 45°, to EAST corner #4, thence 1500 feet NORTHWEST at 315° back to NORTH corner #1, place of beginning.

Tie Point: Beginning at T 18S R 23E survey monument for the NW corner of section 3, thence North 23° 58 minutes 7 seconds East a distance of 1,537 feet to claim corner #1.

The location monument on which this notice is posted is situated within Section 34, Township 17S, Range 23E, Gila Salt River Base and Meridian, Arizona and this claim encompasses portions

of the following quarter section (s), section (s), Township (s) and Range (s) SW and SE ¼ OF SECTION 34 T17S R23E Gila and Salt River Meridian, Arizona.

This Notice of Location has been written to capture mineral rights within its boundaries, only on open and locatable ground. In the case that some or parts of the claim boundaries overlap private or patented land it is understood that no rights or ownership is implied or assumed in relation to that portion of the claim. In the case that any part of this claim boundary may overlap another, pre-existing claim, it is understood that no rights or ownership is implied or assumed in relation to that portion of the claim. Any overlap or overstaking that has occurred is solely due to standard sizing of claims and there is no claim or ownership implied or assumed.

DATED AND POSTED on the ground this 26th day of December, 2017.

LOCATOR (s) Jessica Shuman  
JESSICA SHUMAN (agent for GRE Inc)

RECEIVED  
BLM AZ STATE OFFICE  
2018 DEC 10 P 2:58  
PHOENIX, ARIZONA  
BLM  
Date  
Stamp

AMC 450144

**LOCATION NOTICE FOR LODE MINING CLAIM**

NOTICE IS HEREBY GIVEN that the ABRIL 3

lode mining claim has been located by

GRE INC whose current mailing

address is 331 S RIO GRANDE STREET ST#201, SLC UT 84101

The general course of this claim is NW TO SE and it is situated in COCHISE County, Arizona. This claim is 1500 feet in length and 600 feet in width.

The ABRIL 3 Lode Mining Claim is located pursuant to 43 C.F.R. 3832.12 (b), and described by metes and bounds, including a description of the tie to an official survey monument as follows: Beginning at NORTH corner #1, thence 600 feet southwest at 225° to WEST corner #2, thence 1500 feet SOUTHEAST at 135° to SOUTH corner #3, thence 600 feet northeast at 45°, to EAST corner #4, thence 1500 feet NORTHWEST at 315° back to NORTH corner #1, place of beginning.

Tie Point: Beginning at T 18S R 23E survey monument for the NE corner of section 3, thence North 23° 58 minutes 7 seconds East a distance of 1,537 feet to claim corner #1.

The location monument on which this notice is posted is situated within Section 34, Township 17S, Range 23E, Gila Salt River Base and Meridian, Arizona and this claim encompasses portions of the following quarter section (s), section (s), Township (s) and Range (s) SW and SE ¼ OF SECTION 34 T17S R23E Gila and Salt River Meridian, Arizona.

This Notice of Location has been written to capture mineral rights within its boundaries, only on open and locatable ground. In the case that some or parts of the claim boundaries overlap private or patented land it is understood that no rights or ownership is implied or assumed in relation to that portion of the claim. In the case that any part of this claim boundary may overlap another, pre-existing claim, it is understood that no rights or ownership is implied or assumed in relation to that portion of the claim. Any overlap or overstaking that has occurred is solely due to standard sizing of claims and there is no claim or ownership implied or assumed.

DATED AND POSTED on the ground this 26th day of December, 2017.

LOCATOR (s) Jessica Shuman  
JESSICA SHUMAN (agent for GRE Inc)

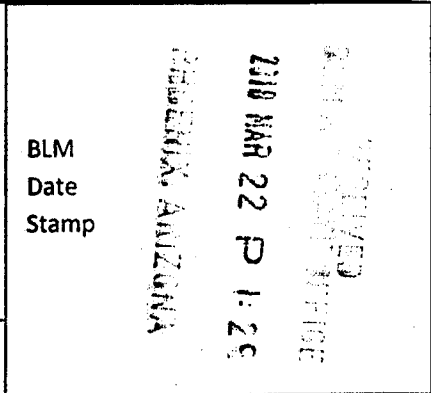

AHCH50144



**MINING CLAIM MAP**

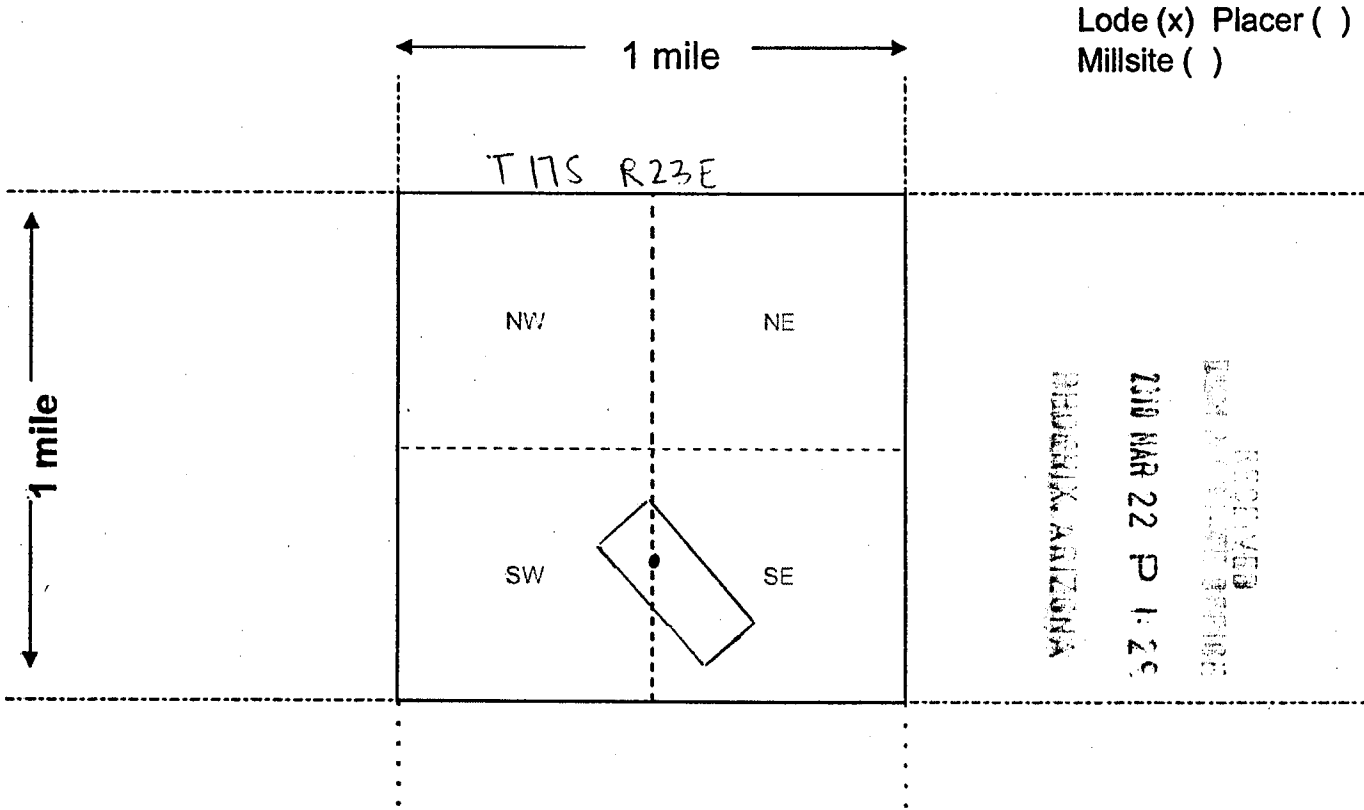

Scale: 1" = 2000 feet



1. The above map depicts the Abril 3 Lode mining claim, which is located in Section 34 Township 17S, Range 23E, Gila & Salt River Base Meridian, Cochise County, Arizona (STATE). Total claim acreage is 20.66

2. The type of corner and location monuments used are as follows: 2"X2" WOODEN STAKES WITH FLAGGING

3. The bearings and distances in degrees and feet between claim corners and to a public land survey monument are as depicted on the map.

4. If the claim is a placer or millsite claim with exterior limits conforming to legal subdivisions of the public survey, provide a legal description of the claim \_\_\_\_\_

Form MCF100a  
Revised July 2014

AH0450144

DEPARTMENT OF INTERIOR  
BUREAU OF LAND MANAGEMENT

Input Parameters for Geographic Report with Land

System Id = CR

Admin State = AZ

Geo State =

Casetype Begins With

Case Disp Txt = AUTHORIZED, CANCELLED, EXPIRED, PENDING, REJECTED, VOID, WITHDRAWN

Mer Twp Rng =

Section =

Mtrs = 14 0170S 0230E 034, 14 0170S 0230E 999

Commodity =

Commodity Txt =

Pending Org =

Pend Org Decode =

Total Rows Returned: 0

TOWNSHIP 17 SOUTH RANGE 23 EAST OF THE GILA AND SALT RIVER MERIDIAN, ARIZONA

COCHISE COUNTY

STATUS OF PUBLIC DOMAIN  
LAND AND MINERAL TITLES  
AND ACQUIRED LANDS

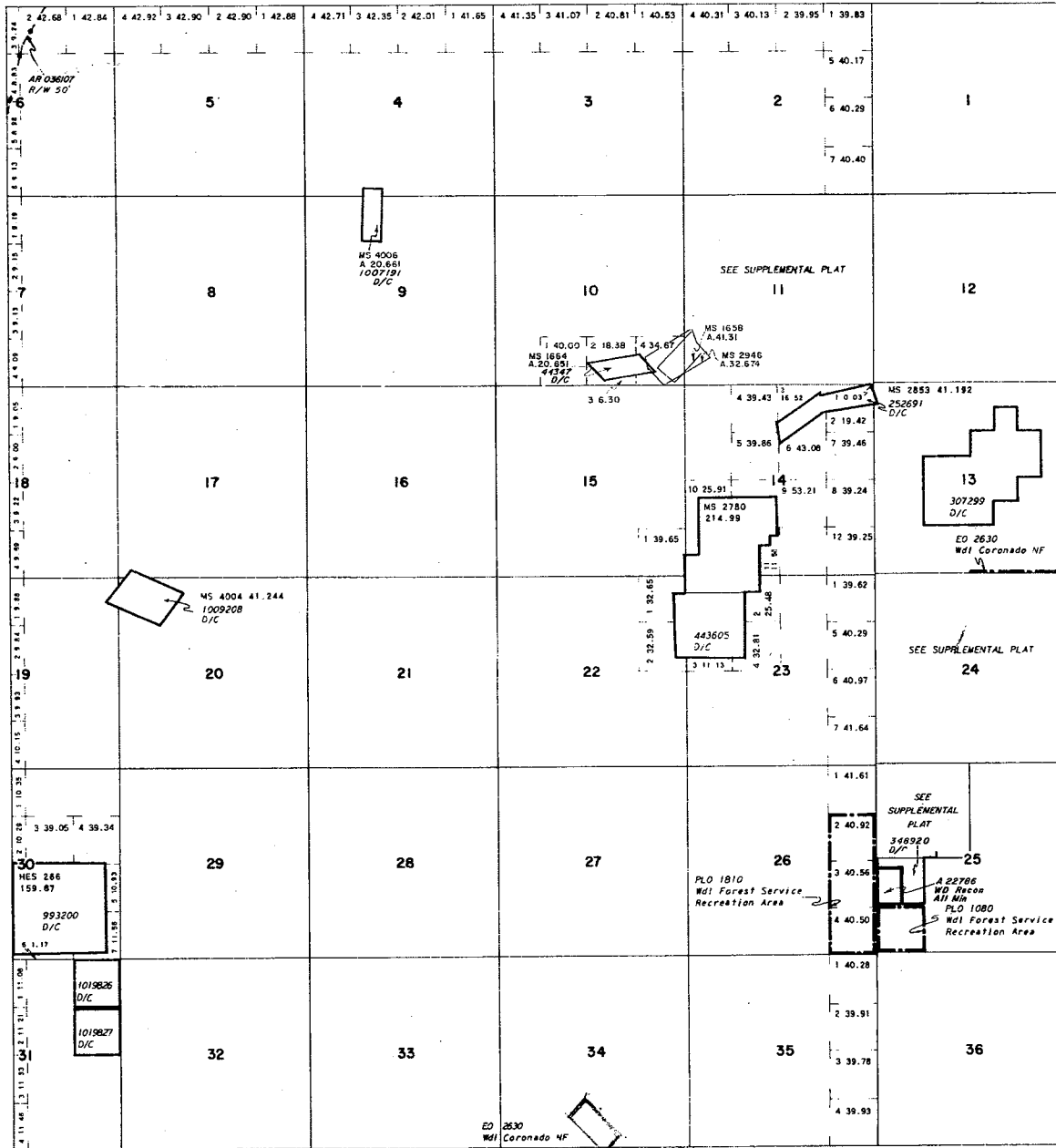

INDEX TO SEGREGATED TRACTS				
RESURVEY	ORIGINAL SURVEY			
	TRACT NO	T	R	SUBDIVISION

FOR ORDERS EFFECTING DISPOSAL OR USE OF  
UNIDENTIFIED LANDS WITHDRAWN FOR CLASSIFICATION,  
MINERALS, WATER AND/OR OTHER PUBLIC PURPOSES,  
REFER TO INDEX OF MISCELLANEOUS DOCUMENTS.

DIST NO. 4

NDS 786 NE  
787 NW  
788 SW  
789 SE

CURRENT TO	BY

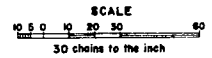

Lat. 31°54'13" N  
Long. 109°56'54" W

**WARNING STATEMENT**  
This plat is the Bureau's Record of Title, and should be used only as a graphic display of the township survey data. Records herein do not reflect title changes which may have been effected by lateral movements of rivers or other bodies of water. Refer to the cadastral surveys for official survey information.

T. 17S.  
R. 23E.

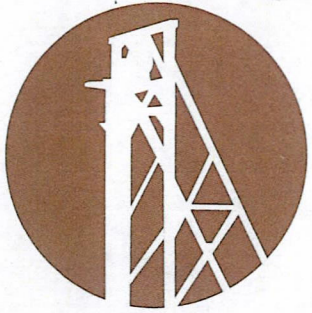

**GOLD RUSH**  
EXPEDITIONS  
GRE Inc

331 S. Rio Grande Street  
Suite #201  
SLC, UT 84101

Arizona BLM  
Attn: Cashier  
One N. Central Ave., Ste. 800  
Phoenix, AZ 85004

CERTIFIED MAIL



7017 0190 0000 7439 2019



\$4.54E US POSTAGE  
0523000001349  
FROM 84101

PROCESSED  
MIM A SERVICE  
218 MAR 22 P 1:29  
PHOENIX, ARIZONA

POSTNET barcode